

# INSTALLATION INSTRUCTIONS | 120V LED Dimmable 3-Color Level Under Cabinet Light: LPU2121, LPU2181, LPU2241 & LPU2321

Note: Before attempting installation please refer to your local electrical code.

## IMPORTANT SAFETY INFORMATION

Please read these instructions carefully before attempting to install this product. It is advisable to keep these instructions in a safe place for further reference.

**WARNING:** These products may represent a possible shock or fire hazard if improperly installed or attached in any way. Products should be installed in accordance with these instructions, current electrical codes and/or the current National Electric Code (NEC).

**WARNING:** To avoid electrical shock, disconnect or disable power at the source prior to installation or maintenance.

**WARNING:** To avoid electrical shock, and to assure proper operation, this fixture must be adequately grounded.

**WARNING:** To avoid electrical shock, use only with 120V AC power input and/or approved cords. Factory warranty will be void if used with any other power input or cords.

**WARNING:** To avoid electrical shock, and to assure proper operation, this fixture must be adequately grounded.

**WARNING:** 12-inch minimum spacing distance from luminaire required for all objects located under fixture.

**WARNING:** Linkable total wattage is 200 Watts.

## SAFETY INSTRUCTIONS

1. The ConTech Lighting LPU2 Undercabinet Light is cETLus listed to UL and CSA standards and intended for indoor use in dry or damp locations. Do not use in the vicinity of standing water or liquids. Do not submerge in water or liquids.
2. Do not use if there is any damage to the unit or to the power cords' insulation. Inspect periodically.
3. Do not route cords or units through walls, doors, windows or any similar part of a building structure.
4. Do not secure unit or its power cord with staples, nails, or any other sharp objects that may damage the cords.
5. Please read and understand these instructions before beginning installation.

## MAINTENANCE & CARE

1. Ensure that the power is disconnected prior to cleaning.
2. To keep the finish of this product, wipe over with soft cloth periodically.
3. Do not use harsh chemical solvents, it may dis-colour or damage the finish.

## PREPARATION FOR INSTALLATION

1. Disconnect electrical power before installing or servicing any part of this fixture.
2. Place fixture on a clean flat surface.
3. Determine input power connection method (Plug-In, Hardwire).

## Components

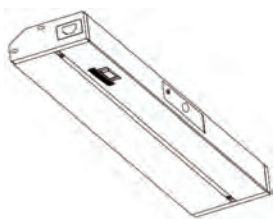

1 x LED 3-Color Level Light

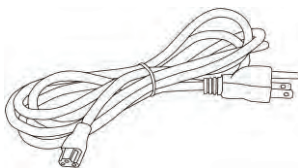

1 x 6 Ft. Power Cord

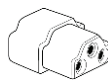

End-to-End Connector



2 x Screws



Jumper Connector

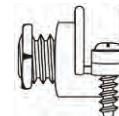

3/8" Electrical Connector

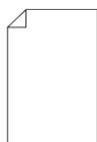

1 x Installation Instructions

All specifications subject to change without notice. For ConTech's limited product warranty, go to [www.contechlighting.com](http://www.contechlighting.com). For a printed copy of the warranty, call 1-847-559-5500.

CONTECH LIGHTING | 725 LANDWEHR ROAD | NORTHBROOK, ILLINOIS 60062 | PHONE 847.559.5500 | [www.contechlighting.com](http://www.contechlighting.com)

© 2020 Conservation Technology of Illinois, LLC. All rights reserved. Note: Specifications subject to change without notice.

LPU2 120V INST REV0121

# INSTALLATION INSTRUCTIONS | 120V LED Dimmable 3-Color Level Under Cabinet Light: LPU2121, LPU2181, LPU2241 & LPU2321

Note: Before attempting installation please refer to your local electrical code.

## INSTALLATION PROCEDURES

### Plug-In Instructions

**FIGURE 1**



Attach the fixture to the cabinet using two (2) included screws.

**FIGURE 2**

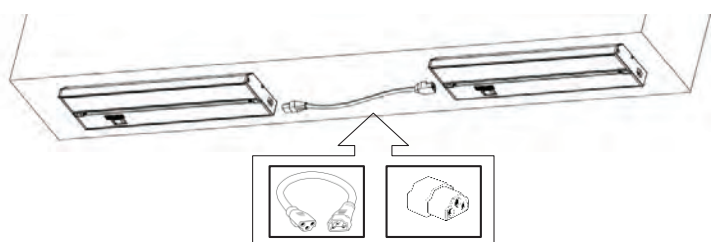

Connect multiple fixtures by plugging in the End-to-End connector or Jumper connector to input and output sides of fixture. Leave connector covers installed on unused connections.

**FIGURE 3**

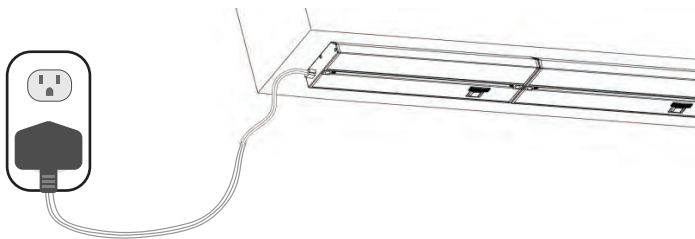

Finally, plug-in the power cord to 120VAC power outlet.

**FIGURE 4**

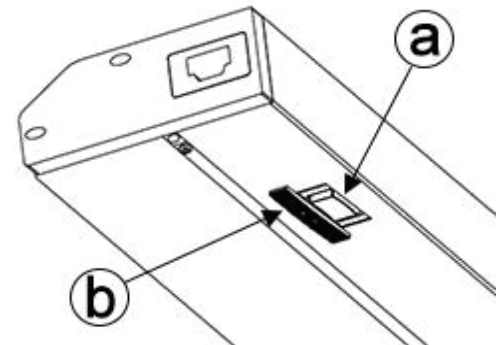

By flipping the switch (a), select between one of the three (3) modes: Lo, Off and Hi.

Switch (b) is used to change the color temperature of light delivered: 2700K, 3000K and 4000K respectively.

**TO PREVENT ELECTRIC SHOCK, MATCH WIDE BLADE OF PLUG TO WIDE SLOT**

**POUR EVITER LES CHOCS ELECTRIQUES, INTRODUIRE LA LAME LA PLUS LARGE DE LA FICHE DANS LA FENTE LA PLUS LARGE**

# INSTALLATION INSTRUCTIONS | 120V LED Dimmable 3-Color Level Under Cabinet Light: LPU2121, LPU2181, LPU2241 & LPU2321

Note: Before attempting installation please refer to your local electrical code.

## INSTALLATION PROCEDURES

### Hardwire Instructions

**FIGURE 1**

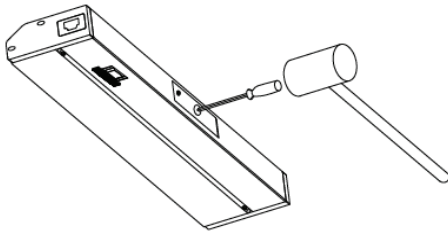

Remove the knock-out with hammer and punch.

**FIGURE 2**

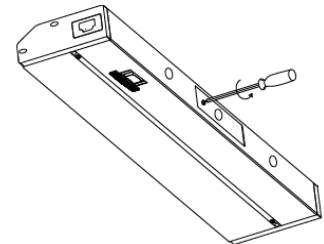

Remove the adapter plate by loosening screw.

**FIGURE 3**

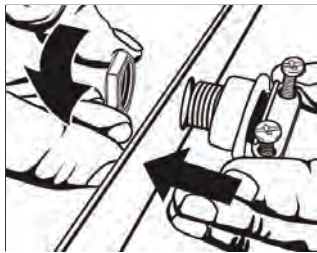

Insert 3/8" electrical connector into the open hole on the adapter. Secure it with the nut.

**FIGURE 4**

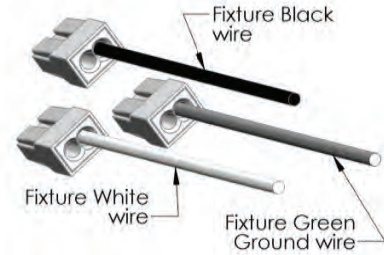

Pull three (3) wires out of the fixture to allow connection to AC supply wires. Insert wires into the open hole of each push-in wire connector.

**FIGURE 5**

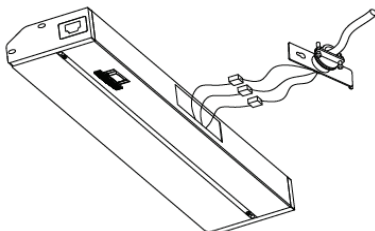

- Connect the Green Ground Input Supply Wire to the fixture Green Ground Wire
- Connect the White AC Neutral Supply Wire to the fixture White Wire
- Connect the Black AC Line Voltage Supply Wire to the fixture Black Wire

**\*Do not mix wires or change polarity\***

**FIGURE 6**

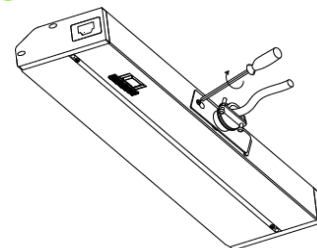

Feed wires back into fixture, re-attach adapter plate, tighten screw and attach the fixture to the base of cabinet with screws as shown in Step 1 and 2 of Plug-in Instructions above.