

CTL600

Universal Lampholder with Optional Shades

Specifications/Features

Fixture

Economic design choice for simplicity and flexibility in applications. Adjustable socket for proper seating of any size PAR lamp; thumb-screw locks seating position.

Stem style mounting arm has Sure-Set aiming adjustment for accurate positioning.

Two deep baffle shades, LA-30 and LA-40, are available to conceal the lamp and create a step-cylinder fixture silhouette.

May be track mounted or used in mono-point applications with the LA-18 mono-point accessory.

Precise, rigid aiming and full 350° rotation.

Integral ON/OFF switch and track polarity indicator are standard.

LF-30 Shade will accept (1) LF30 lens, Egg Crate Louver (LA-38) or Barn Doors (BD30) by using the FA-30 accessory holder.

LF-40 Shade will accept (1) LF40 lens, Egg Crate Louver (LA-39) or Barn Doors (BD40) by using the FA-40 accessory holder.

Max. Lamp

(1) 50W PAR20, 75W PAR16, 75W PAR30 or 250W PAR38; 120V, E26 medium base.

Warranty

This fixture is covered by ConTech's full one (1) year replacement guarantee after date of purchase.

Listing

cCSAus Certified. Suitable for dry locations.

Fixture Compatibility

Standard ConTech track fixtures are cCSAus Certified as-is for use with Con-Tech's many track systems, as well as with Juno®¹ Lighting track. By changing the prefix in the part number, ConTech can install inserts which make our fixtures compatible with other manufacturers. Replace "CTL" with "HTL" for Halo®² track, "LTL" for Lightolier®³ track, and "PTL" for Capri®⁴ track. For more information, please consult our factory.

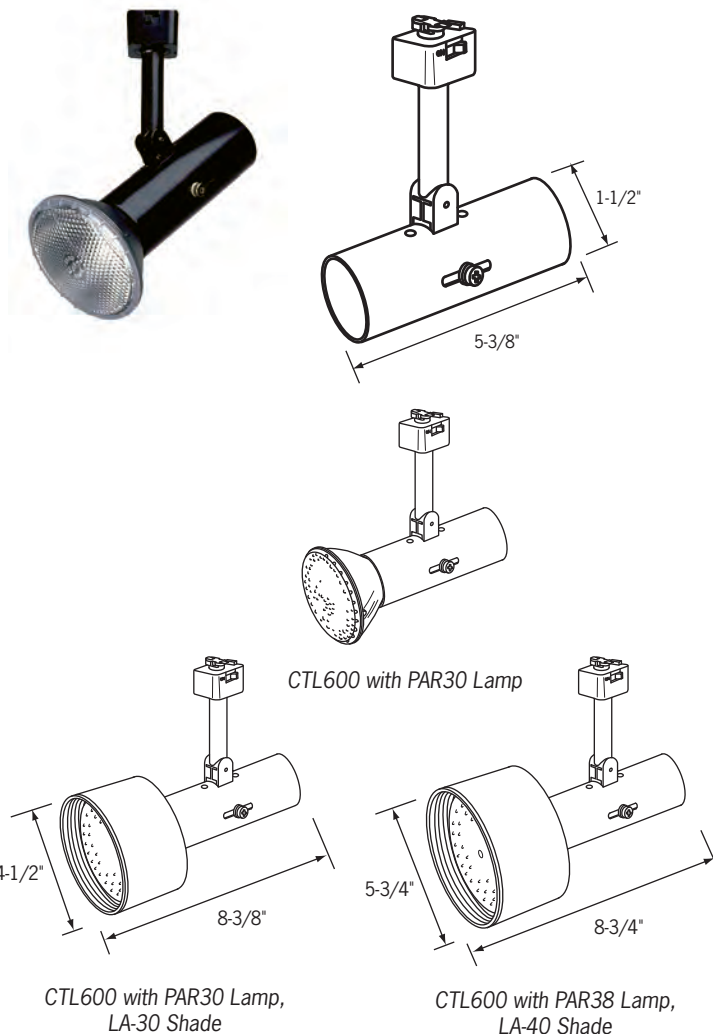

Ordering Information

Example Order:

CTL600

—

P

LA30-P

FA-30

LF30-LS

Fixture

Finish

Lampshade

Black Accessory Clips

Accessories



CTL600

B - Black
P - White

LA-30-(B, P) - PAR30 Baffled Lamp shade, Black Baffle
LA-40-(B, P) - PAR38 Baffled Lamp shade, Black Baffle

FA-30 - For use with LA-30 Shade
FA-40 - For use with LA-40 Shade

LF30-(A, B, CL, G, LB, R, RO, Y, 73, LS, SL, UV)
4-11/16" Dia. Tempered Glass Lenses for use with LA-30 Shade
LA-38-(B,P,S) - Egg-Crate Louver for use with LA-30 Shade
BD30 - Black Barn Doors for use with LA-30 Shade
LF40-(A, B, CL, G, LB, R, RO, Y, 73, LS, SL, UV)
5-7/16" Dia. Tempered Glass Lenses for use with LA-40 Shade
LA-39-(B,P,S) - Egg-Crate Louver for use with LA-40 Shade
BD40 - Black Barn Doors for use with LA-40 Shade

Color/Pattern Legend

-A (Amber), -B (Blue), -CL (Clear), -DPE (Dichroic Peach), -G (Green), -LB (Light Blue), -R (Red), -RO (Rose), -Y (Yellow), -73 (Spread Lens), -LS (Linear Spread Lens), -SL (Soft Light), -UV (Optivex UV Filter)

1. Juno is a registered trademark of Juno Lighting
2. Halo is a registered trademark of Cooper Lighting
3. Lightolier is a registered trademark of Philips Lighting
4. Capri is a registered trademark of Philips Lighting